

URBAN lettings



Angell Road, London, SW9 7HL

£2,200 Per Month

- Finished to High Standard Throughout
- Secure Gated Parking
- Separate Living Room
- Excellent Transport Links
- Second (Top) Floor Flat
- Bike Shed & Walled Gardens
- Approx. 650 sq ft
- Private Development
- Modern Bathroom & Kitchen
- Wood Floors & Double Glazing

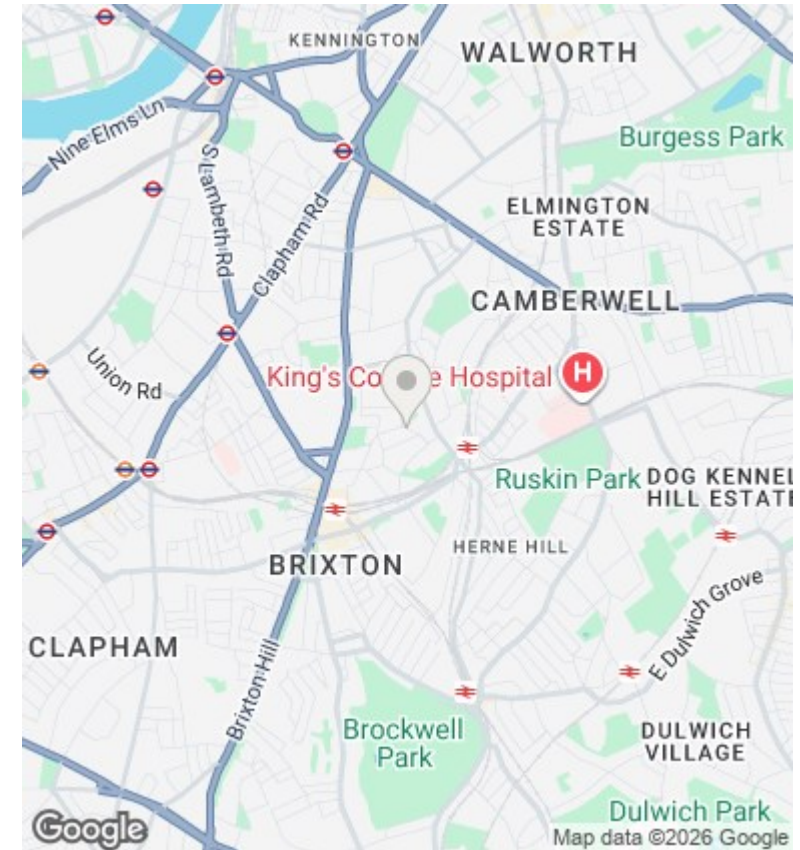
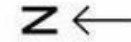
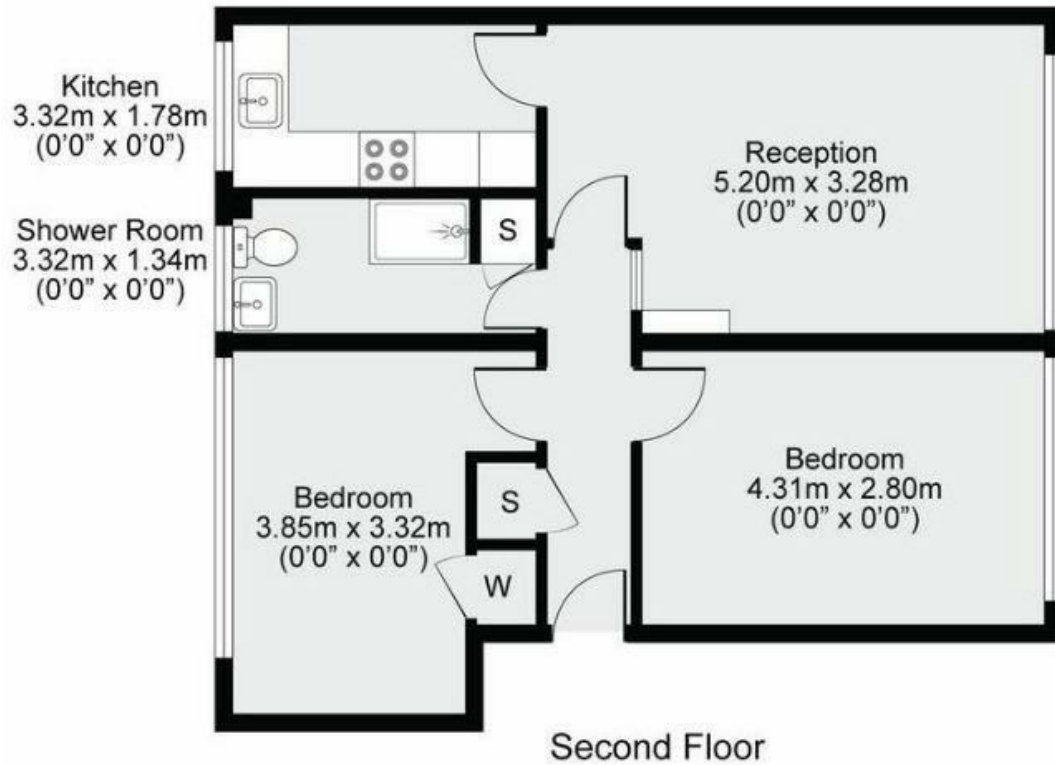

Directions

Viewings

Viewings by arrangement only. Call 020 7585 2761 to make an appointment.

Council Tax Band

B

EPC Rating:

D

Energy Efficiency Rating		Current	Potential
<i>Very energy efficient - lower running costs</i>			
(92 plus)	A		
(81-91)	B		
(69-80)	C		78
(55-68)	D	67	
(39-54)	E		
(21-38)	F		
(1-20)	G		
<i>Not energy efficient - higher running costs</i>			
England & Wales		EU Directive 2002/91/EC	